

PROPERTY OF OIL-RITE CORPORATION

This print is loaned only and subject to return upon demand, and upon the express condition that it is not to be reproduced or copied, or information from it furnished to others, or to be used in any way detrimental to the interests of Oil-Rite Corporation.

REV	CO NO	CHANGE	BY	DATE	APVD
A	13485	ITEM -24 WAS A-4957-47 & REMOVED YB-3009-2 & B-2925-2	SD	01-08-02	MW
B	14692	ITEM -29 WAS A-5087-1	JK	09-22-06	MW
-	-	-	-	-	-

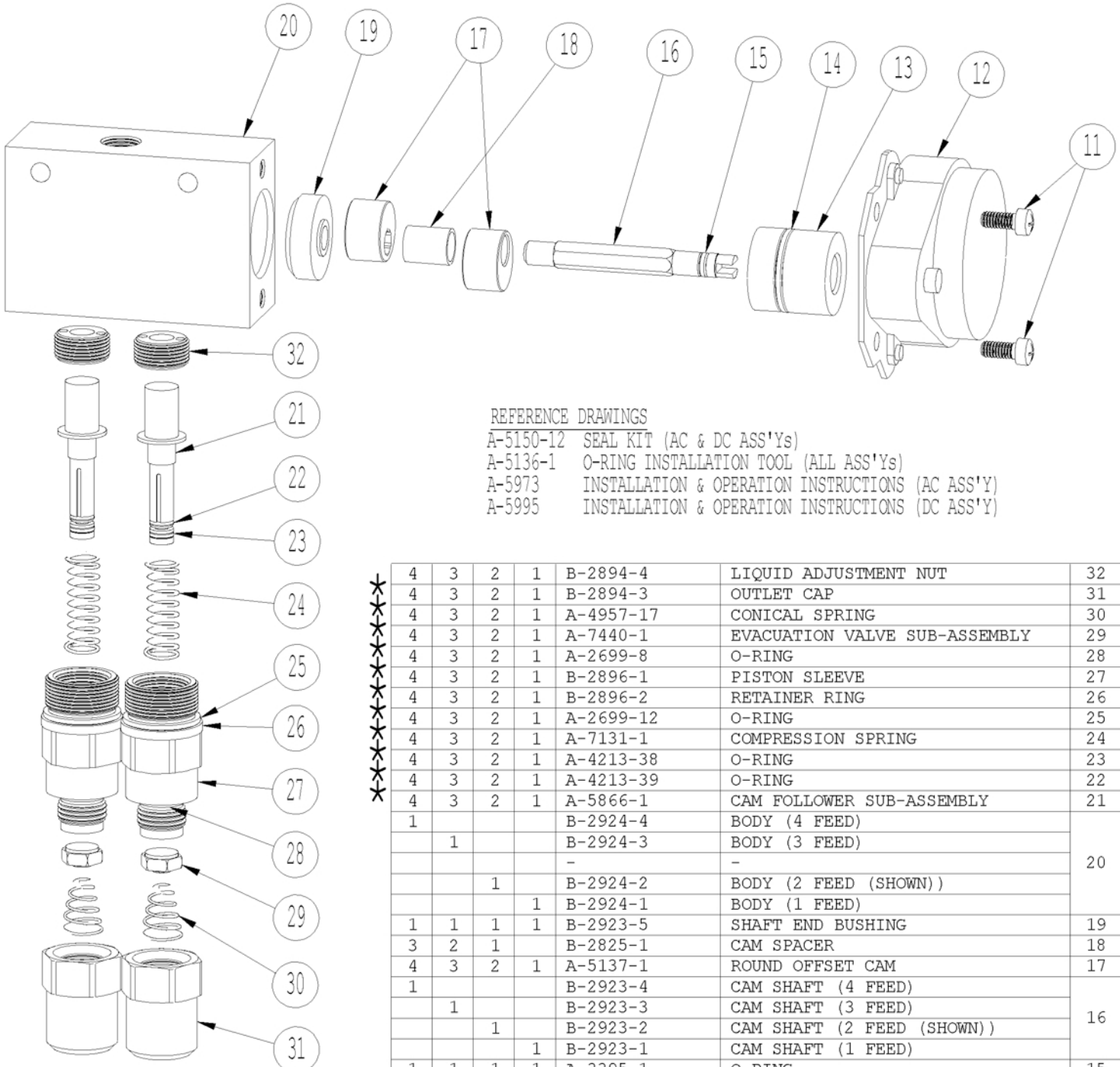

REFERENCE DRAWINGS

- A-5150-12 SEAL KIT (AC & DC ASS'Ys)
- A-5136-1 O-RING INSTALLATION TOOL (ALL ASS'Ys)
- A-5973 INSTALLATION & OPERATION INSTRUCTIONS (AC ASS'Y)
- A-5995 INSTALLATION & OPERATION INSTRUCTIONS (DC ASS'Y)

*	4	3	2	1	B-2894-4	LIQUID ADJUSTMENT NUT	32
*	4	3	2	1	B-2894-3	OUTLET CAP	31
*	4	3	2	1	A-4957-17	CONICAL SPRING	30
*	4	3	2	1	A-7440-1	EVACUATION VALVE SUB-ASSEMBLY	29
*	4	3	2	1	A-2699-8	O-RING	28
*	4	3	2	1	B-2896-1	PISTON SLEEVE	27
*	4	3	2	1	B-2896-2	RETAINER RING	26
*	4	3	2	1	A-2699-12	O-RING	25
*	4	3	2	1	A-7131-1	COMPRESSION SPRING	24
*	4	3	2	1	A-4213-38	O-RING	23
*	4	3	2	1	A-4213-39	O-RING	22
*	4	3	2	1	A-5866-1	CAM FOLLOWER SUB-ASSEMBLY	21
*	1				B-2924-4	BODY (4 FEED)	20
*		1			B-2924-3	BODY (3 FEED)	
*			1		B-2924-2	BODY (2 FEED (SHOWN))	
*				1	B-2924-1	BODY (1 FEED)	
*	1	1	1	1	B-2923-5	SHAFT END BUSHING	19
*	3	2	1		B-2825-1	CAM SPACER	18
*	4	3	2	1	A-5137-1	ROUND OFFSET CAM	17
*	1				B-2923-4	CAM SHAFT (4 FEED)	16
*		1			B-2923-3	CAM SHAFT (3 FEED)	
*			1		B-2923-2	CAM SHAFT (2 FEED (SHOWN))	
*				1	B-2923-1	CAM SHAFT (1 FEED)	
*	1	1	1	1	A-3395-1	O-RING	15
*	1	1	1	1	A-2699-13	O-RING	14
*	1	1	1	1	B-2923-6	MOTOR END BUSHING	13
*					B-3201-1	MOTOR SUB-ASS'Y DC MTG BRACKET	12
*					B-3201-2	MOTOR SUB-ASS'Y DC ELECTRICAL BOX	
*					-	-	
*					B-2925-1	MOTOR SUB-ASS'Y AC MTG BRACKET	
*					B-2925-6	MOTOR SUB-ASS'Y AC ELECTRICAL BOX	
*	2	2	2	2	B-3000-1	PHILLIPS SCREWS	11
*	4	3	2	1			

* ITEMS -21 THRU -31 CAN BE REPLACED WITH A-5930-1 CARTRIDGE SUB-ASSEMBLY

PAT NO's: 4,784,578 & 5,984,652



TOLERANCES UNLESS OTHERWISE SPECIFIED
 FRACTIONAL ± 1/64
 DECIMAL .XXX ± .020
 DECIMAL .XXXX ± .005
 DECIMAL .XXXXX ± .002
 ANGLES ± 1 DEG
 ASSEMBLIES: ALL DIMENSIONS ARE REF.

SCALE: 1.5:1
 DATE: 10-31-00
 DRAWN: SD
 APV'D: MW

TITLE:
 SPARE PARTS LIST FOR INTERNALLY
 ADJUSTABLE MOTOR OPERATED
 PurgeX ASS'Ys B-3429 & B-3473

DRAWING NUMBER:
A-5972

REV
B
 09-22
 2006